

# HAMMER IN PLUG FOR AERATED CONCRETE

**SQUARE**



AERATED CONCRETE



## FEATURES

**Materials:** glass and nylon composite

**Avantages :**

- very resistant in cellular concrete
- no need to drill, installed simply with a hammer
- suitable for 3.5-6mm wood screw

## INSTALLATION

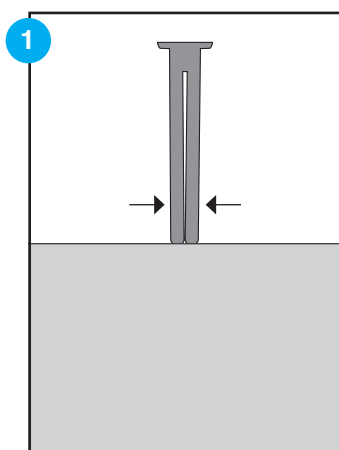

1 Make a mark on the surface of the concrete. Hold the plug on its end with your fingers (cf picture 1)

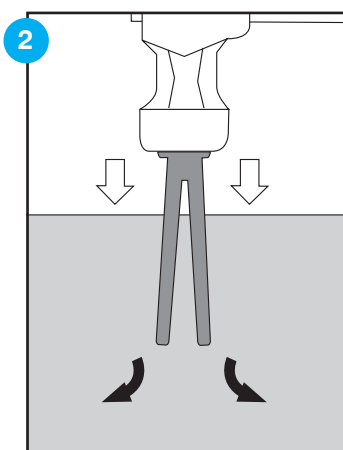

2 Hammer the plug by little repeated strokes into the concrete surface. The 'arms' of the plug will spread inside cellular concrete to create a «V», creating a solid anchoring

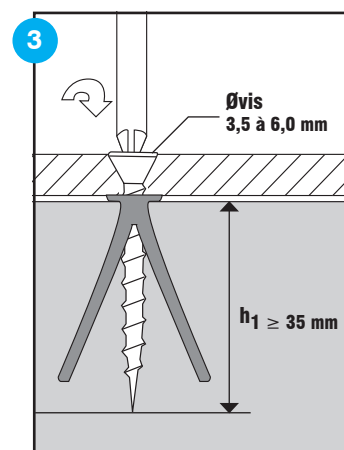

3 insert a wood screw Ø3,5 to Ø6,0 respect the minimum recommended implantation depth  $h_1 \geq 35$  mm

## RECOMMENDED LOADS

These tensile loads are given for information based on trials conducted by Scell-it for  $h_1 = 35$  mm. For a use requiring strict value it is recommended to conduct extraction trials in situ.

