

MULTI-FUNCTION SWIVEL HEAD RIVETER

FOR BLIND RIVETS

— USER MANUAL —

R100P



min.
Ø **2.4** mm



max.
Ø **4.8** mm

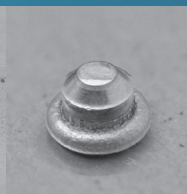

TOOL CAPACITIES AND SPECIFICATIONS

Tool capacity:

BLIND RIVETS	Ø2.4 3/32	Ø3.0/3.2 1/8	Ø4.0 5/32	Ø4.8/5.0 3/16
ALUMINIUM	✓	✓	✓	✓
STEEL	✓	✓	✓	✓
STAINLESS STEEL	✓	✓	✓	✓

Weight: 900 g

Body material: Cast aluminium

Adjustable handles: Steel

Handles grip: ABS

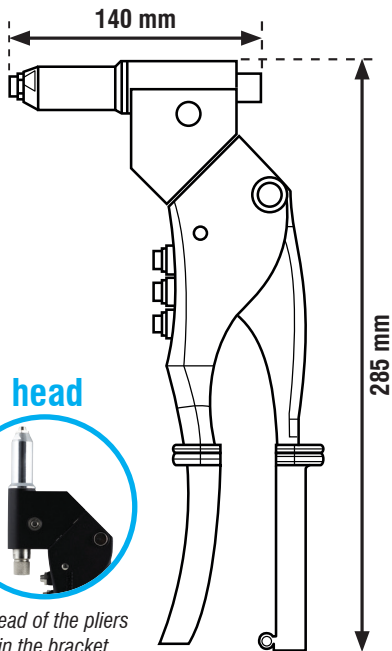

360° pivoting head



NB: If necessary, rotate the head of the pliers to gain access to the hole in the bracket

Nose pieces included:

Rivet diameter		N°	Included
(mm)	(inches)		
2,4	3/32	3	Standard
3,0/3,2	1/8	4	Standard
4,0	5/32	5	Standard
4,8	3/16	6	Standard

Keys included:



WARNING!

Keep out of reach of children. Wear safety glasses when operating tool.

OPERATION

EN

FR

PL

• How riveting a rivet?

1 Drill hole.



Close the tool handles.

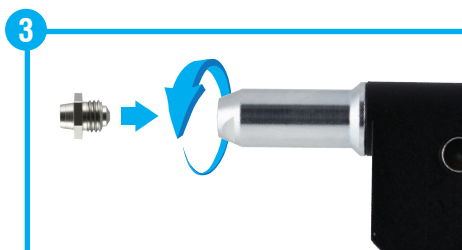

Select and remove nosepiece for the size of blind rivets to be used.



Open the tool handles.

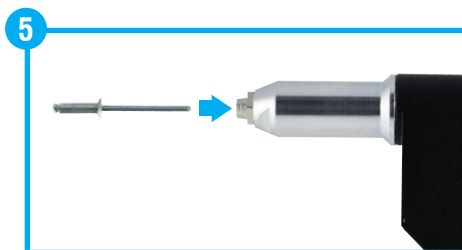

Insert rivet into tool and insert the rivet into the hole in the bracket.

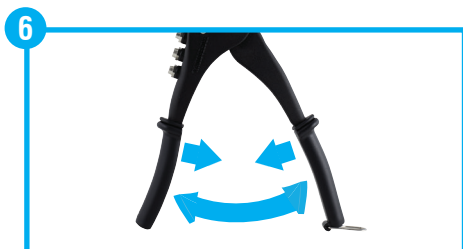

Squeeze handles (several times if necessary) until the nail breaks.



When handles are released rivet stem will come out.

• How changing of nosepieces?

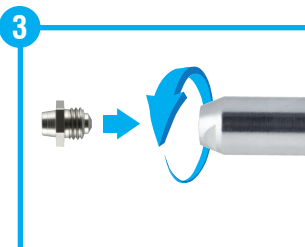
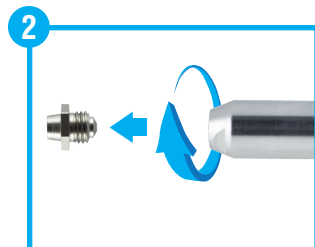
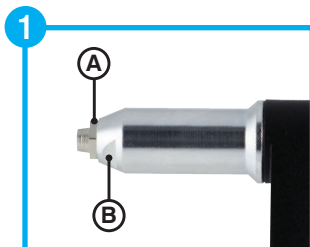

• How replacing used jaws?

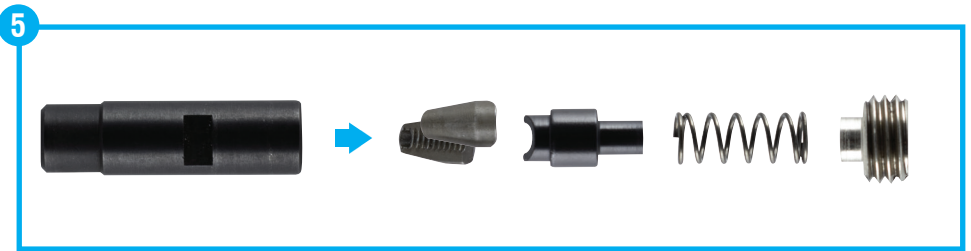
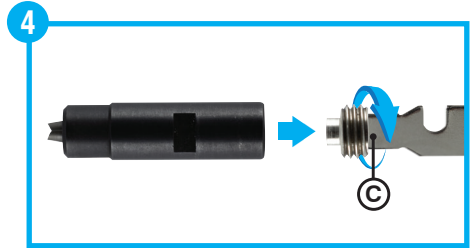
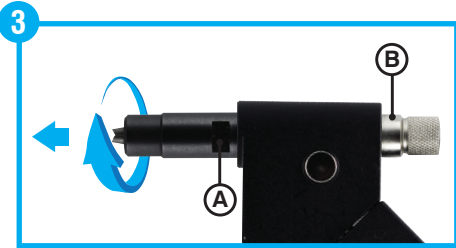
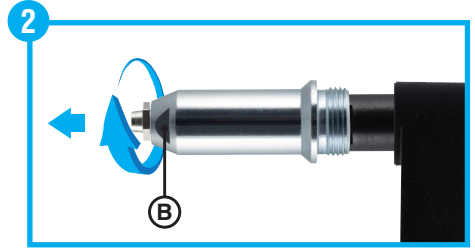

• Explosion drawing

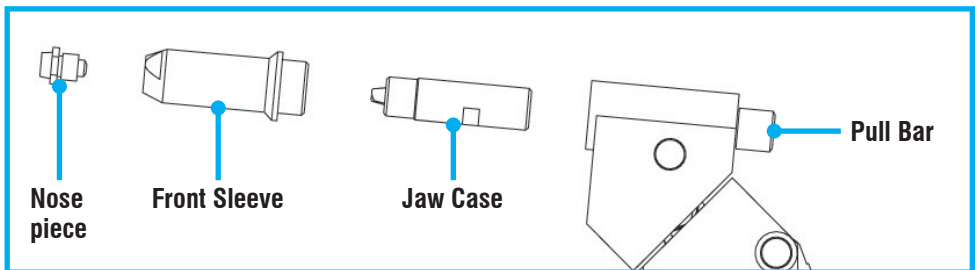

CARACTÉRISTIQUES ET DIMENSIONS DE LA PINCE

EN
FR
PL

Capacité d'usage :

RIVETS AVEUGLES	Ø2.4 3/32	Ø3.0/3.2 1/8	Ø4.0 5/32	Ø4.8/5.0 3/16
ALUMINIUM	✓	✓	✓	✓
ACIER	✓	✓	✓	✓
INOX	✓	✓	✓	✓

Poids : 900 g

Matière corps : fonte d'aluminium

Matière poignée mobile : Acier

Grip poignée : Plastique ABS

Tête pivotante à 360°



NB : Faire pivoter si nécessaire la tête de la pince pour accéder au trou du support

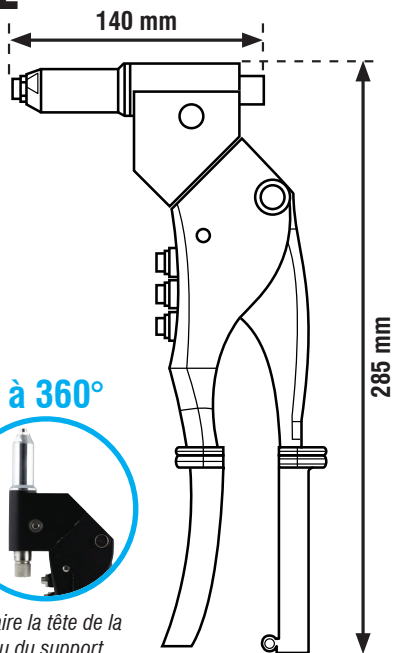

Nez fournis :

Diamètre		N°	Inclus
(mm)	(inches)		
2,4	3/32	3	Standard
3,0/3,2	1/8	4	Standard
4,0	5/32	5	Standard
4,8	3/16	6	Standard

Clés fournis :



AVERTISSEMENT !

Tenir hors de portée des enfants. Port des lunettes obligatoire.

UTILISATION

• Comment sertir un rivet ?

1 Percer le support à l'aide d'un foret correspondant au diamètre du rivet.



Fermer les bras de la pince.

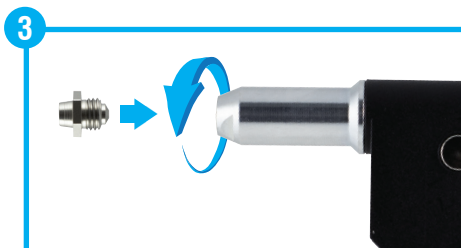

Mettre en place le nez de pose correspondant au diamètre du rivet.



Ouvrir les bras de la pince.

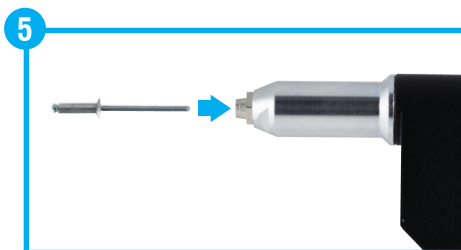

Mettre le clou du rivet en place dans le nez de pose et introduire le rivet dans le trou du support.

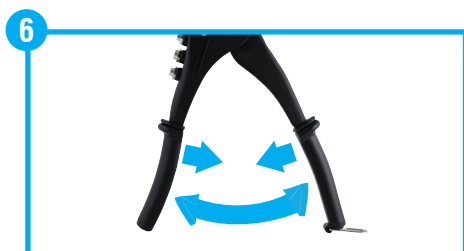

Actionner les bras de la pince (plusieurs fois si nécessaire) jusqu'à rupture du clou.



Ouvrir les bras de la pince pour libérer le clou cassé.

• Comment changer de nez ?

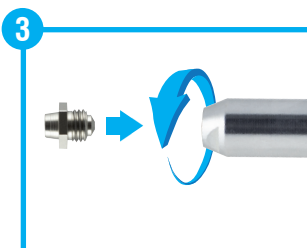
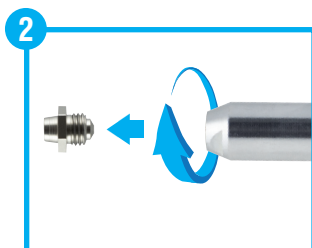
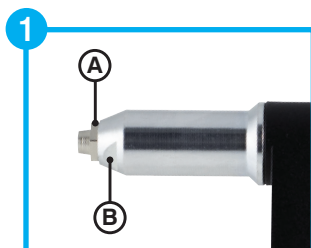

• Comment remplacer les jeux de mors ?

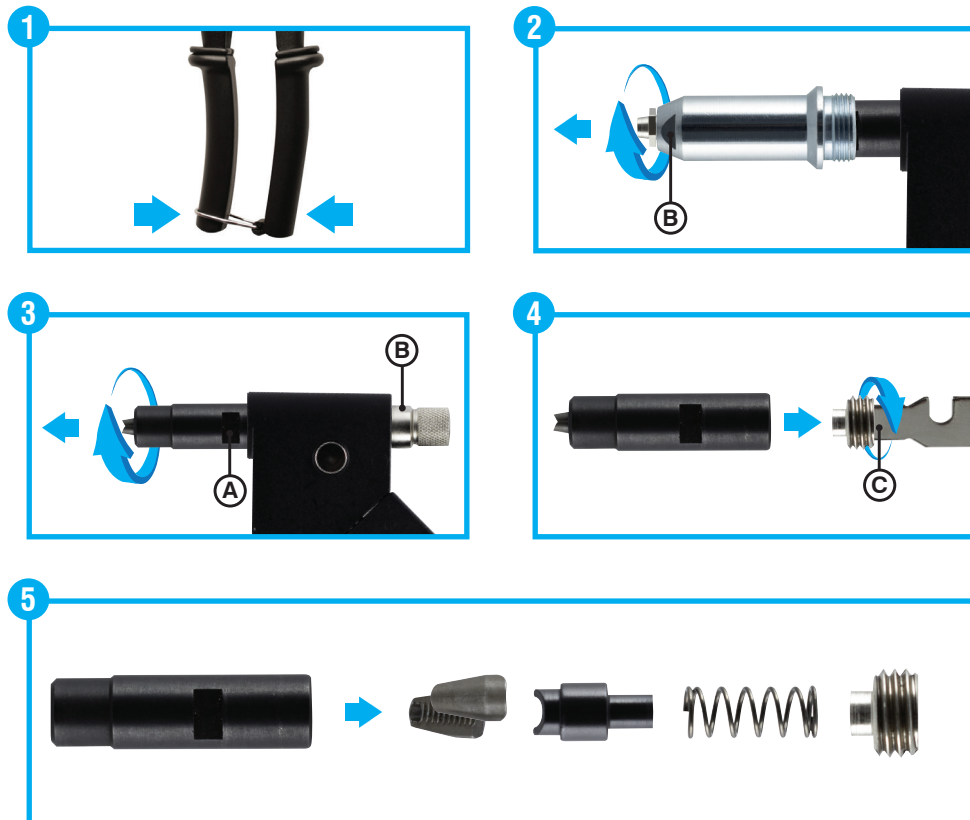

• Vue éclatée

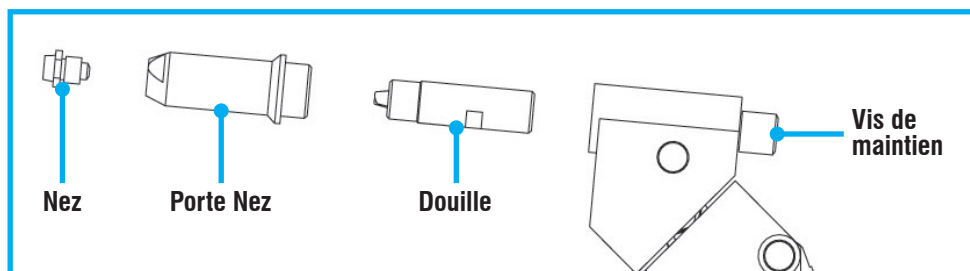

Scell-it®
SERVICE TECHNIQUE

28 rue Paul Dubrule - Tél. : 03 20 32 98 18 - technique@scellit.com - www.scellit.com

ZAKRES NARZĘDZIA I SPECYFIKACJA

Zastosowanie:

NITY ZRYWALNE	Ø2.4 3/32	Ø3.0/3.2 1/8	Ø4.0 5/32	Ø4.8/5.0 3/16
ALUMINIUM	✓	✓	✓	✓
STAL	✓	✓	✓	✓
STAL NIERDZEWNA	✓	✓	✓	✓

Waga: 900 g

Materiał głowica: Aluminium

Ruchome uchwyty: Stal

Materiał uchwyty: ABS plastik

Obrotowa głowica 360°



Uwaga: W razie potrzeby obróć głowicę narzędzia, aby uzyskać dostęp do wywierconego otworu

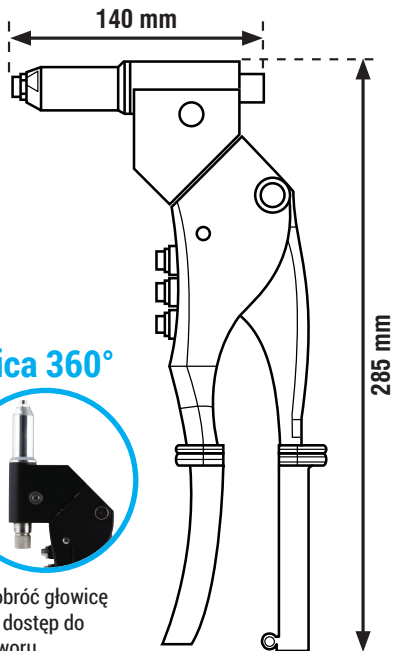

Noski w zestawie:

Nity rozmiar		N°	W zestawie
(mm)	(cale)		
2,4	3/32	3	Standard
3,0/3,2	1/8	4	Standard
4,0	5/32	5	Standard
4,8	3/16	6	Standard

Kluczem w zestawie:



UWAGA!

Chronić przed dziećmi. Noś okulary ochronne podczas obsługi narzędzia.

• Jak zerwać nit?

1 Wywiercić otwór odpowiadający średnicy nitu za pomocą wiertarki.



Zamknąć ramiona nitownicy.

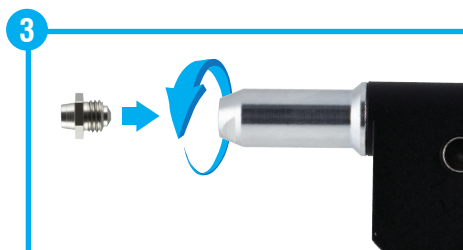

Przygotuj nosek odpowiadający średnicy nitu.



Otwórz ramiona nitownicy.

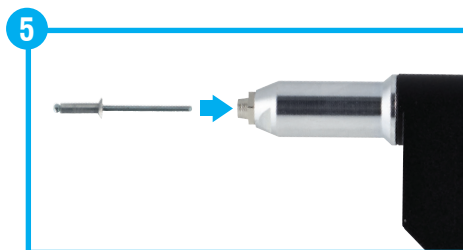

Umieść nit w otworze noska i wprowadź nit w wywiercony otwór.



Ruszać ramionami nitownicy (kilka razy, jeśli to konieczne), aż do momentu zerwania trzpienia nitu.



Otwórz ramiona nitownicy, aby uwolnić złamany trzpień.

• Jak zmienić nosek?

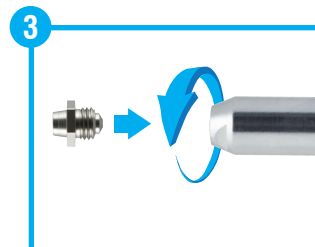
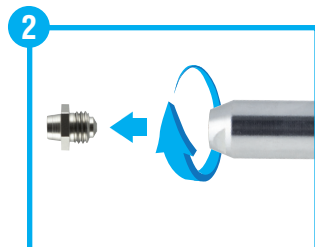
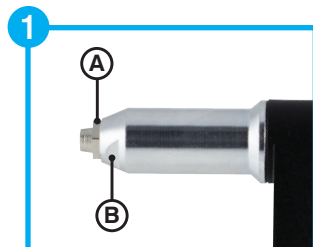

•Jak zmienić szczęki?

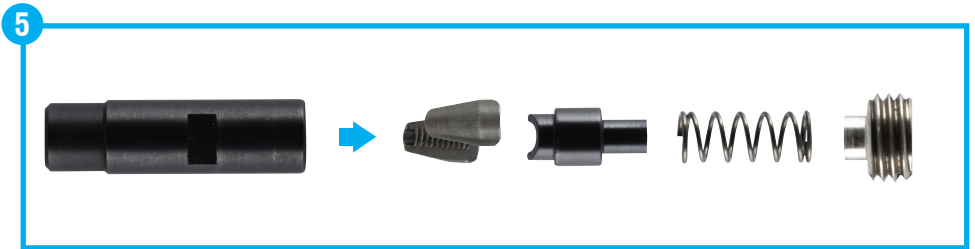
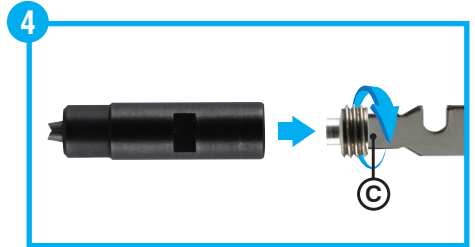
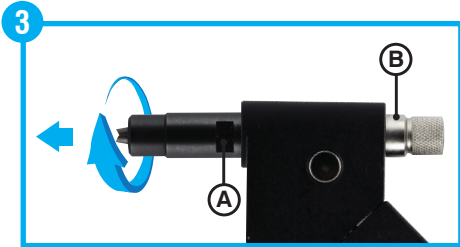
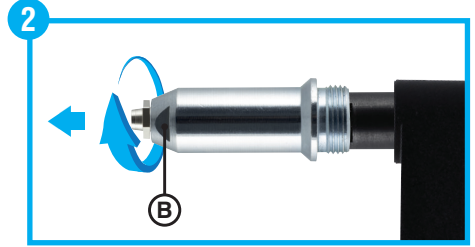

•Widok w stanie rozłożonym

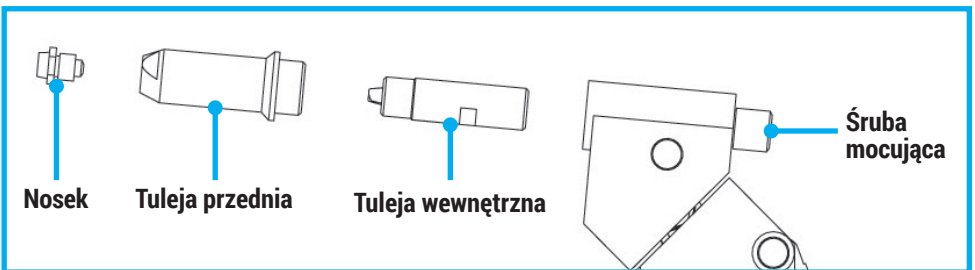

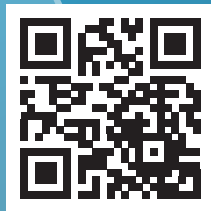

www.Scellit.com