



# OPERATING INSTRUCTIONS

Cutter sets	Ø Circle drilling (+0.10/-0)
M4	Ø 6.2 - 6.3 mm
M5	Ø 7.2 - 7.3 mm
M6	Ø 9.2 - 9.3 mm
M8	Ø 11.5 - 11.6 mm
M10	Ø 13.5 - 13.6 mm

**1** Pre-drill the metal sheet with a round hole, according to the table.

**4** push the puller to the front against the cutter.  
It will spread the 3 blades of the cutter.

**2** Pull the puller to the rear end.

**5** Press the button of the tool to cut the hex-hole.

**3** Insert the cutter tip into the pre-drilled hole.  
To be sure that the cutter is horizontal to the workpiece, check that the surface of anvil is fully in contact with the workpiece surface.

**6** After setting, push once more the trigger if necessary in order to get rid of metal chips remained on cutter.

## CHANGE CUTTER SETS

### STANDARD SUPPLIED

#### SIZES M5, M6 AND M8

Changing anvil + locknut and cutter

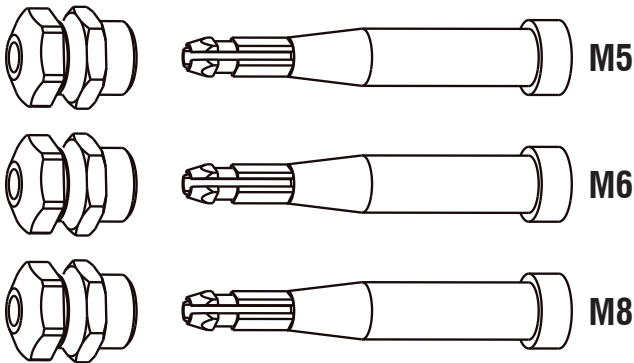

### IN OPTION

#### SIZE M10

Changing anvil M10 + locknut M10

Cutter M10

Nose sleeve M10

Connecting sleeve M10

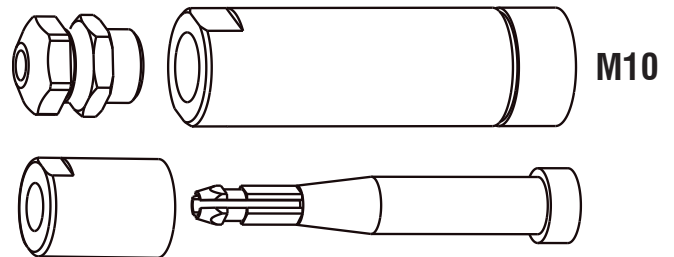

### IN OPTION

#### SIZE M4

Changing anvil M4 + locknut M4

Cutter M4

Puller rod M4

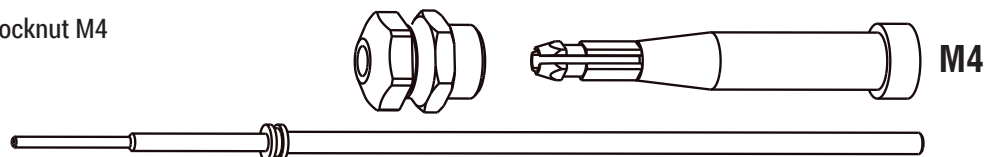

For further details, please refer to the user manual.

## MAINTENANCE / TROUBLESHOOTING / SAFETY INFORMATION

See user manual.