

■ Scell-it® ■

VI-P300_B / VI-P420_B

CAULKING GUN

BATTERY 7.2V - 1.5Ah



EN

INSTRUCTION MANUAL

OVERVIEW



Battery pack
7.2V - 1.5Ah

**Transformer
(Charger)**

VI-P300_E
Gun

VI-P420_E
Gun

- 1 Carriage**
Cartridge holder
- 2 Push plate**
Parts contact and squeeze with the cartridge plunger.
- 3 Plunger rod**
The forward movement of the plunger rod applies pressure to the bottom of an open cartridge tube, causing caulk to be dispensed.
- 4 Pull knob**
The pull knob is used to retract the plunger rod, allowing caulk pack to be loaded. The plunger rod can only be moved while the plunger rod release button is pressed.
- 5 Rod release button**
Pressing the plunger rod release button allows you to pull the plunger rod backward.
- 6 Trigger**
Pressing the trigger starts the forward motion of the plunger rod.
- 7 Trigger lock**
The trigger lock prevents depression of trigger.
- 8 Ventilation holes**
- 9 LED indicator**
- 10 Speed adjustment wheel**
Adjusts the extraction speed
- 11 Wrist belt**
Worn on the wrist for safety purpose.
- 12 Battery pack release buttons**
To release the battery back.

Indicateur LED

| LED Color | LED Signal Function | Operation Status |
|---------------------|--------------------------------------|---|
| ● WHITE light | Rod goes forward | Normal operation |
| ☀ Flash WHITE light | Rod goes backward | Normal operation |
| ● Flash GREEN light | Over Voltage Protection (OVP) | Automatically Power off when the status occurs. |
| ● RED light | Battery Low Voltage Alarm | Please charge the Li-ion Battery. |
| ☀ Flash RED light | Battery Low Voltage Protection (LVP) | Automatically Power off when the status occurs. |
| ☀ Flash BLUE light | Overcurrent Protection (OCP) | Automatically Power off when the status occurs. |
| ● BLUE light | Over Temperature Protection (OTP) | Automatically Power off when the status occurs. |

GETTING STARTED

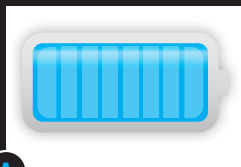

A Check up on the battery pack to be fully charged and firmly loaded.

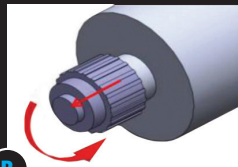

B Release and remove the coaxial cartridges cap.

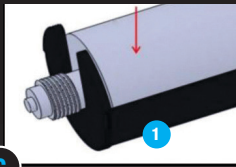

C Load the cartridges into carriage. **1**

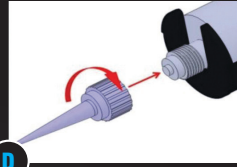

D Tighten the static mixer.



E Pull the trigger for operation. **6**

Battery loading and removal



To remove the battery pack, press the battery release buttons and pull. **12**

To load the battery pack, slightly push the battery pack upward to the handle housing.

Loading caulk material



Press the rod release button. **5**

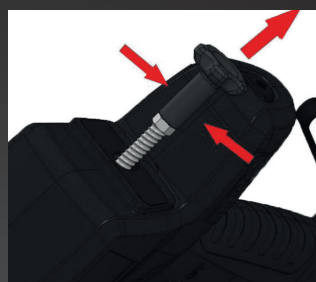

Hold the pull knob and pull it back **4**.

Locking the trigger



Lock the trigger **6** when the tool is not in use. To lock the trigger, push trigger lock **7** at OFF site, the tool will not operate.

Turn unit off and disconnect battery pack before installing and removing accessories or performing maintenance.

Start and stop

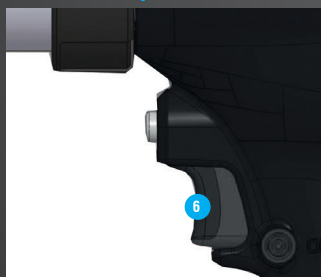

Press trigger **6** to dispense caulk.

Stepless speed control disk [DS series only]

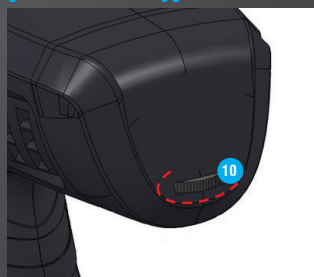

Turn the disk from Left (Low) to Right (High) for desired dispensing speed. Maximum achievable speed on the trigger once the desired speed is set on the disk.

Don't start the tool from the lowest point. The speed sometimes is too slow to be noticed. **10**

Trouble Shooting

If the release button is stuck, please gently pull and release the trigger, this will retract the ball screw automatically and release the pressure. Then the release button is functional.

MAINTENANCE & CLEANING

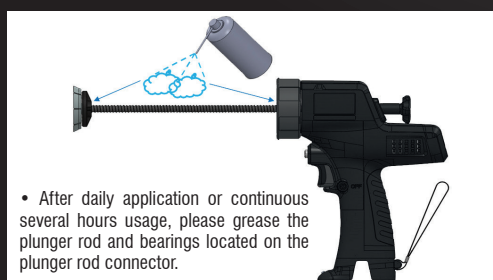

• After daily application or continuous several hours usage, please grease the plunger rod and bearings located on the plunger rod connector.

• If the tool does not start or operate at full power with a fully charged battery pack, clean the contacts on the battery pack. If the tool still does not work properly, return the tool, charger and battery pack to service facility for repairs.

• Clean dust and debris from charger and tool vents. Keep tool handles clean, dry and free of oil or grease. Use only soap and a damp cloth to clean the tool, battery pack and charger since certain cleaning agents and solvents are harmful to plastics and other insulated parts. Some of these include gasoline, turpentine, lacquer thinner, paint thinner, chlorinated cleaning solvents, and ammonia, which may consist in household detergent.

• Never use flammable or combustible solvents on tools.

WARNING



Never remove the plunger rod off the tool in any case, otherwise it will cause failure of spheres locating which makes the gun fail to work. Keep the plunger rod clear and neat at all times. A plunger rod covered with adhesive may damage the whole mechanism. The warranty expires when adhesive goes into the mechanism; in addition, any maintenance fee occurred will be charged by the repair service facility.





In case of that residual material left on the plunger rod, please clean it up thoroughly before pulling the rod to the backward position. The purpose is to prevent the material from entering the inner mechanism and keeping the tool in good condition.

BATTERY CHARGING



7.2V - 1.5Ah Li-Ion Battery



Charging 
Complete charge 



Connect the power core to the DC terminal at bottom of the battery first, and then plug the compact transformer into the A.C. power outlet.

It takes approximately 1~1.5 hours to get fully charged battery.

IMPORTANT

RECHANGABLE BATTERY POWER TOOL USE AND CARE

- Ensure the lock switch is in « off » position before inserting battery pack.
- Use only original manufacturer supplied charger to charge original manufactured battery.
- Use of any other battery packs may cause damage or fire.
- When battery pack is not in use, keep it away from other metal objects like paper clips, coins, keys, nails, screws or other small metal objects that can make a connection from one terminal to another. Shorting the battery terminals may cause burns or a fire.
- Under abusive conditions, liquid may be ejected from the battery, please avoid contact. If contact accidentally occurs, flush and clean with water. If liquid contacts eyes, look for medical help immediately. Liquid ejected from the battery may cause irritation or burns.
- If the performance of the battery diminishes substantially even it has been fully charged, the life of battery is terminated, please replace a new one.
- Do not keep the battery in recharge for more than 2 hours. This could reduce battery life.
- Wet or overheat condition will reduce battery life.
- When discarding batteries, environmental issues must be considered. The local rules or laws governing the disposal of battery must be followed strictly.

Maintaining battery pack

The battery packs will operate for years and/or hundreds of cycles when they are maintained and used according to these instructions.

- A battery pack that is stored for six months without using will discharge itself. Batteries discharge at a rate of about 1% per day. Charge the battery every six months even it is unused to maximize battery life. Replace this battery pack until it no longer performs the power needed for your application.
- Store your battery pack in a cool, dry place. Do not store at place where the temperature may exceed 50°C such as in a vehicle or metal storage during the summer. High temperature will overheat the battery pack, and reduce battery life. If it is stored for several months, the battery pack will gradually lose its power. During the life of the battery pack, the operating time between charges becomes shorter. If the operating time becomes extremely short after a proper charge, the life of the battery pack has been terminated and it should be replaced.

GENERAL SAFETY RULES

Work area safety

Keep work area clean and well lit. Cluttered or dark areas cause accidents easily.

- Do not operate power tool in explosive atmospheres, such as in the presence of flammable liquids, gases or dust. Power tools create sparks which may ignite the dust or fumes.
- Keep children and bystanders away while operating a power tool. Distractions can cause you to lose control.

Electrical safety

Power tool plugs must match the outlet. Never modify the plug in any way. Do not use any adapter plugs with earthed (grounded) power tools. Correct plugs and matching outlets will reduce risk of electric shock.

- Avoid body contact with grounded surfaces such as pipes, radiators, ranges and refrigerators. There is an increased risk of electric shock if your body is grounded.
- Do not expose power tools to rain or wet conditions. Water entering a power tool will increase the risk of electric shock.
- Do not abuse the cord. Never use the cord for carrying, pulling or unplugging the power tool. Keep cord away from heat, oil, sharp edges or moving parts. Damaged or entangled cords increase the risk of electric shock.
- When operating a power tool outdoors, use an extension cord suitable for outdoor use. Use of a cord suitable for outdoor use reduces the risk of electric shock.

Personal safety

Stay alert, watch what you are doing and use common sense when operating a power tool. Do not use a power tool while you are tired or under the influence of drugs, alcohol or medication. A moment of inattention while operating power tools may result in serious personal injury.

- Use safety equipment. Always wear eye protection. Safety equipment such as dust mask, non-skid safety shoes, hard hat or hearing protection used for appropriate conditions will reduce personal injuries.
- Avoid accidental starting. Ensure the switch is in the off-position before plugging in. Carrying tools with your finger on the switch or plugging in power tool that have the switch on invites accidents.
- Do not overreach. Keep proper footing and balance at all times. This enables better control of the power tool in unexpected situations.
- Dress properly. Do not wear loose clothing or jewelry. Keep your hair, clothing and gloves away from moving parts. Loose clothes, jewelry or long hair can be caught in moving parts.
- If devices are provided for the connection of dust extraction and collection facilities, ensure these are connected and properly used. Use of these devices can reduce dust-related hazards.
- Working at high place with this caulking gun, please notice working environment safety.