

WHD CLOSED END 3.2/4.0/4.8



WHD3.2-4.8FICHE

For installation information please refer to the tooling overview and manuals on our website www.scell-it.com
 Pour les conditions de pose, merci de vous référer à la description de l'outil et aux manuels disponibles sur notre site web.
 Angaben zur Verarbeitung entnehmen Sie bitte der Geräteübersicht und den Betriebsanleitungen auf unserer Website.
 Pro informace ohledně montáže navštivte naše webové stránky nebo nahlédněte do manuálu k nářadí.

ENGLISH	FRANÇAIS	DEUTSCH	CZECH
Mandrel : Aluminium	Tige : Aluminium	Dorn : Aluminium	trn : Hliník
Body : Aluminium	Corps : Aluminium	Körper : Aluminium	ďřík : Hliník
Dome head	Tête plate	Flachrundkopf	plochá hlava

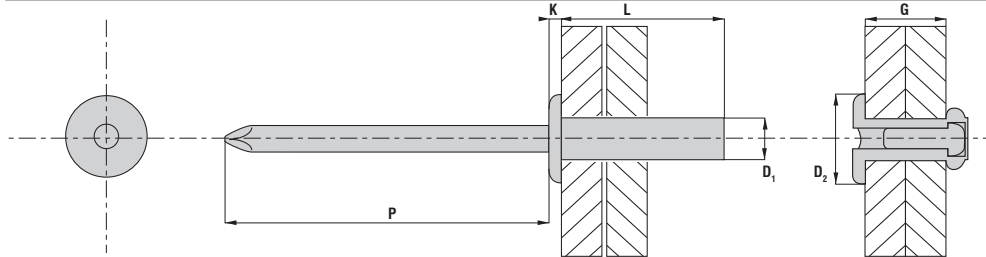

PART NO/REF	D ₁	L	D ₂	K	Hole diameter	P	G
	Ø (mm)	(mm)+1.0 / -0.2	Ø (mm)	(mm)	Ø (mm)	mini (mm)	min-max (mm)
WHD3208	3.2 +0.08 / -0.15	8.0	6.0 ±0.29	1.4 -0.3 / +0.0	1.8	27	0.5-3.5
WHD3209		9.5					3.5-5.5
WHD4010	4.0 +0.08 / -0.15	9.5	8.0 ±0.29	1.70 -0.4 / +0.0	2.20	27	0.5-5.0
WHD4012		12.5					5.0-8.0
WHD4809	4.8 +0.08 / -0.15	9.5	9.5 ±0.29	2.00 -0.5 / +0.0	2.65	27	1.0-4.5
WHD4811		11.5					4.5-6.5
WHD4814		14.5					6.5-9.5
WHD4818		18.0					9.5-13.0

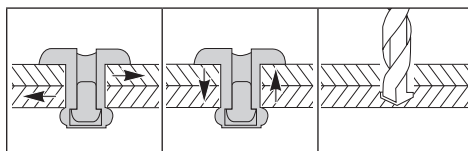

D ₁ (mm)	(N)	(N)	Ø (mm)
3.2	450	490	3.3
4.0	580	820	4.1
4.8	900	1 120	4.9

UNIT PLANT CERTIFICATES



ISO 9001:2000
TS 16949

Scell-it®
Engineering & Development

© 2009 Blue future Intellectual Proterities

Data shown are subject to change without prior notice as a result of continuous product development and improvement policy.
Your local Scell-it representative is at your disposal should you need to confirm latest information.