

RIVET NUT SETTING TOOL

USER MANUAL

E-612NH



DESIGNED IN FRANCE BY
Scell-it®

min.

M5



max.

M12



TOOL CAPACITIES AND SPECIFICATIONS

Capacities : M5 à M12

Net weight : 1,10 kgs

Dimensions : 160 mm x 210 mm

Stroke : 0 - 7 mm

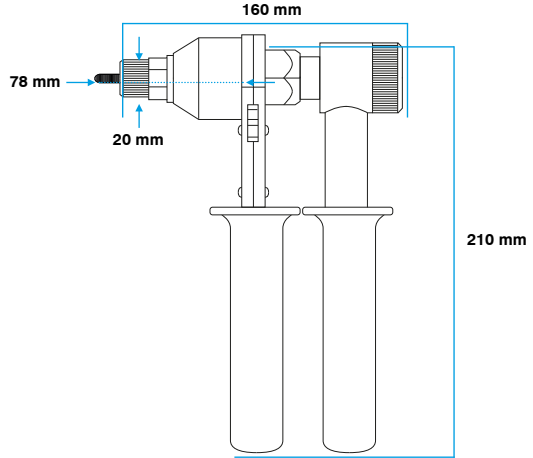

OPERATIONS

1. REAR LEVER RETURN TO INITIAL POSITION

1 Switch to setting mode (left side -up).

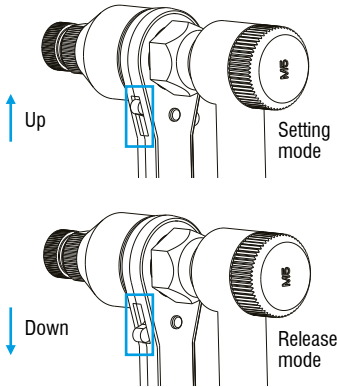

2 turn rear lever clockwise tool ready to set when ratchet sound heard.

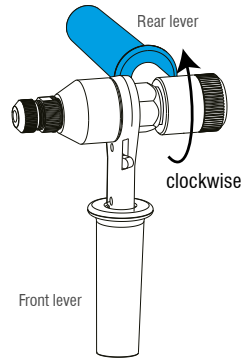

INSTALLATION OF BOLTS PULLER

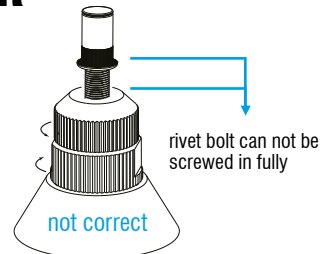
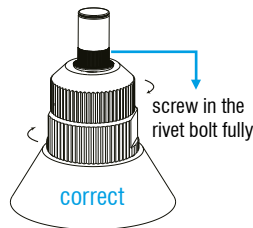
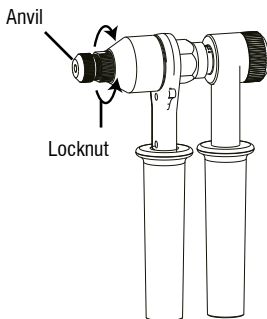

to adjust the anvil unlock clockwise, then screw on locknut, until the rivet bolt fits

2.SETTING

- 1 Feed on rivet nut or rivet bolt correctly
- 2 Setting with either way shown below, repeat until set

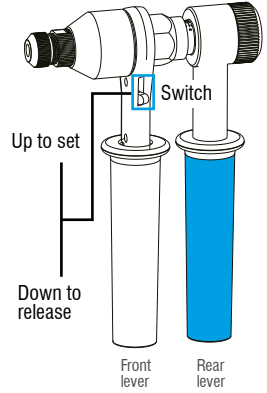
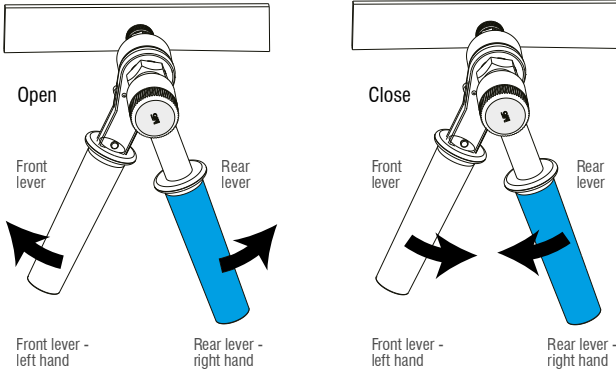

3.FINISH SETTING

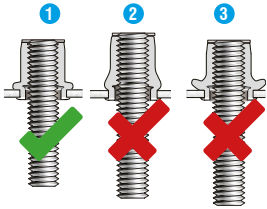

- 1 Correctly setting
- 2 Not fully set
- 3 Over-set. Do not pull the rivnut up too tightly as you may strip the thread in the rivnut or damage the tool mandrel.

Rivet bolt not correctly fed

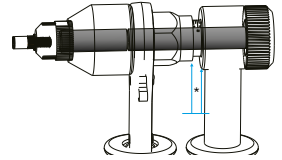

*Gap

Tool not ready

4.TOOL RELEASE

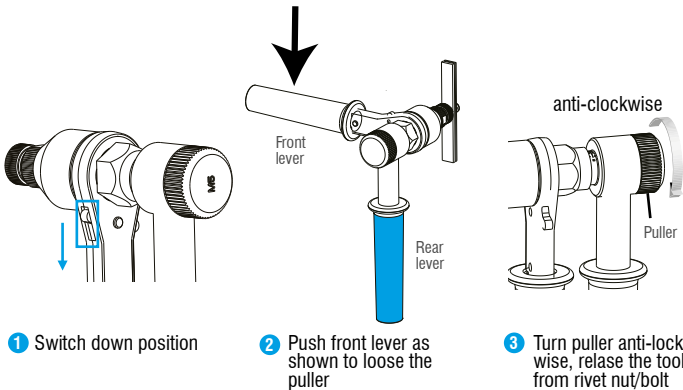

Rivet bolt fed

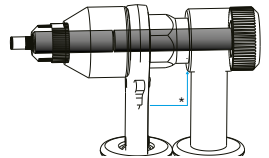

*Rotate de rear handle anti-clockwise 1-2 turns to create the 1mm gap.

Tool ready

5.CONTINUE TO WORK FOLLOWING 1, 2, 4 STEPS ABOVE, TO CONTINUE SETTING MORE RIVET NUTS/BOLTS.

UNINSTALLATION OF PULLER

1. SCREW OFF ANVIL AND LOCKNUT

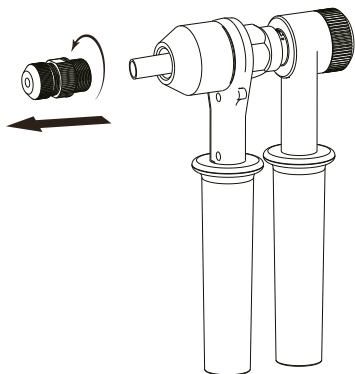

2. PULLING OUT THE PULLER

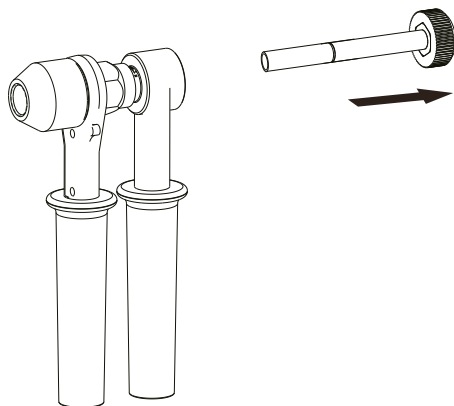

3. INSERT THE PULLER FROM THE TOOL BACK

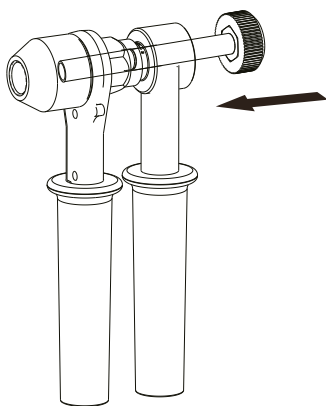

4. SCREW ON LOCKNUT THEN ANVIL

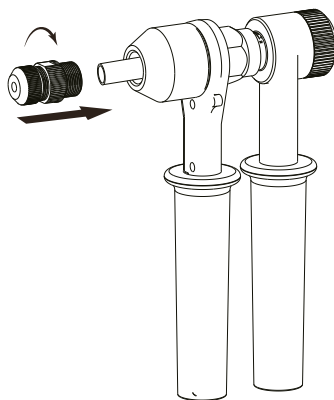

Note : anvil size and puller size shall be the same