

SK - COUNTERSUNK HEAD

Mandrel: Steel. Body: Steel. Countersunk Head.

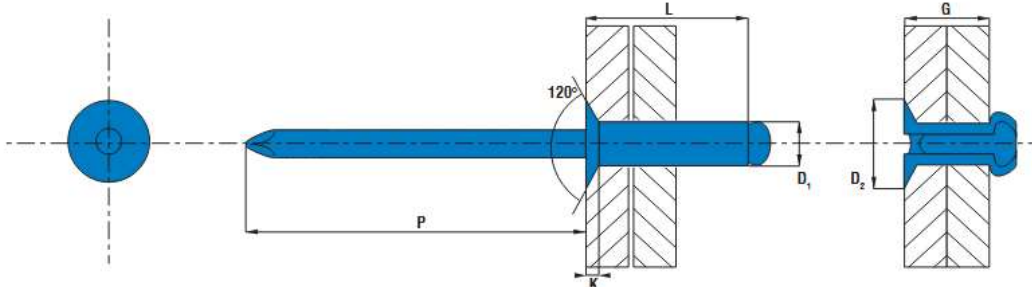

PART NO/REF	D ₁	L	D ₂	K	Hole diameter	P	G
	Ø (mm)	(mm)+1.0 / -0.2	Ø (mm)	(mm)	Ø (mm)	mini (mm)	min-max (mm)
SK3206	3.2 +0.08 / -0.10	6.0	6.0 -0.4 / +0.0	0.9 -0.2 / +0.2	3.3	27	1.5-3.0
SK3208		8.0					3.0-5.0
SK3210		10.0					5.0-7.0
SK3212		12.0					7.0-9.0
SK4006	4.0 +0.08 / -0.10	6.0	7.5 -0.5 / +0.0	1.0 -0.2 / +0.2	4.1	27	1.5-2.5
SK4008		8.0					2.5-4.5
SK4010		10.0					4.5-6.5
SK4012		12.0					6.5-8.5
SK4016		16.0					10.5-12.5
SK4808	4.8 +0.08 / -0.10	8.0	9.0 -0.5 / +0.0	1.2 -0.2 / +0.2	4.9	27	1.5-4.5
SK4810		10.0					4.0-6.0
SK4812		12.0					6.0-8.0
SK4814		14.0					8.0-10.0
SK4816		16.0					10.0-11.5
SK4820		20.0					13.5-15.5

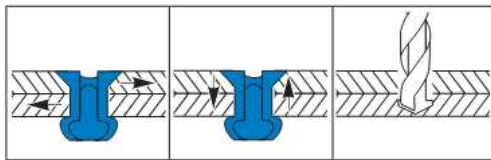

D ₁ (mm)	(N)	(N)	Ø (mm)
3.2	1 100	1 285	3.3
4.0	1 700	2 200	4.1
4.8	2 900	3 100	4.9