

SPECIAL ASPHALT ANCHOR - XFALT



CHARACTERISTICS

Materials: Screw and sleeve: White zinc-plated steel
Protective cap: Nylon

Benefits : Removable female attachment.
Excellent grip in asphalt.

APPLICATION EXAMPLES



INSTALLATION

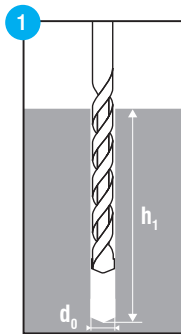

1 Drill a hole with a hammer drill at diameter d_0 and at recommended depth h_1 .

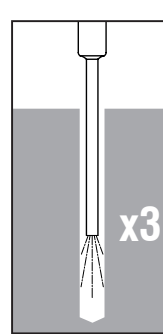
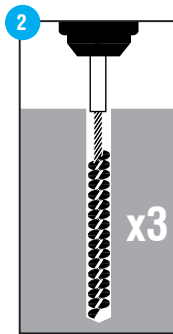

2 Eliminate dust with a brush metal or by blowing (pump manual blower or pressurized air). Repeat operation 3 times.

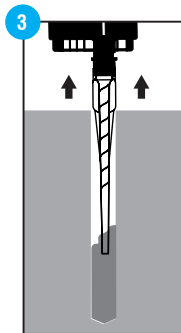

3 Inject the sealant chemical according to installation data.

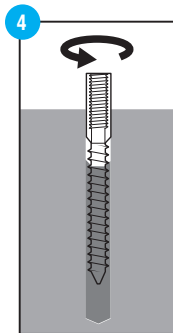

4 Rotate the X-FALT pin at the hand (with the help of the cap if necessary) plastic) in the chemical seal before hardening, until it is at the same level as the ground.

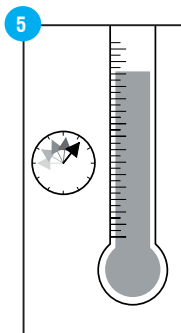

5 Allow time to dry indicated on the data of implementation of chemical sealing (drying time). During this period, he is recommended to mount the plastic cap on the socket, to prevent it does not fill with water or of dust.

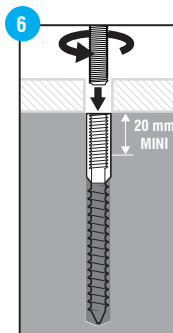

6 Remove the plastic cap and attach the object to using a threaded rod + washer/nut or with a metric screw. It is advisable to screw the threaded rod to the minimum of 20 mm to guarantee a good connection and good hold of the fixed object. The maximum driving length of the threaded rod in the socket is given in the dimension table on the back (T value).

SPECIAL ASPHALT ANCHOR - XFALT

APPLICATION DATA

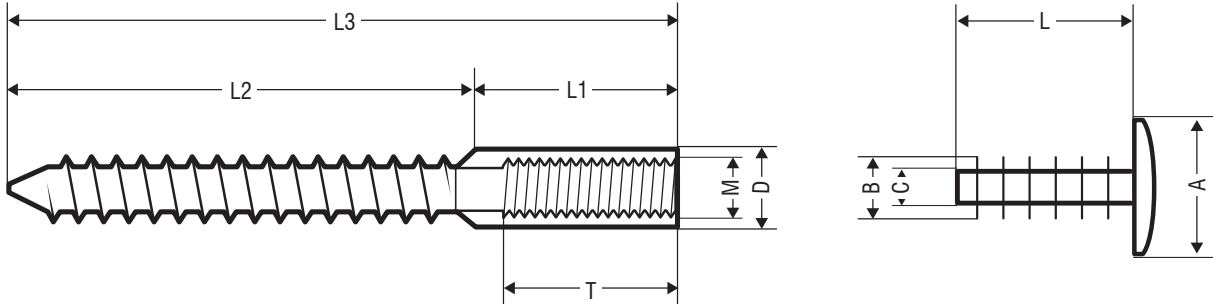

Ref	Screw / sleeve part						Nylon part				Assembly data	
	M	D mm	L1 mm	L2 mm	L3 mm	T mm	A mm	B mm	C mm	L mm	d0 Ø drilling mm	h1 drilling depth mm
X-FALT-M08X100	M8	10	40	60	100	20	17	7.6	4.2	31	12	110
X-FALT-M10X100	M10	12	40	60	100	30	19	9.6	4.7	31	14	110
X-FALT-M12X140	M12	14	60	80	140	40	21	11.6	5.7	31	16	150