

PIN AND COLLAR

TAINERBOLT FT / FTC

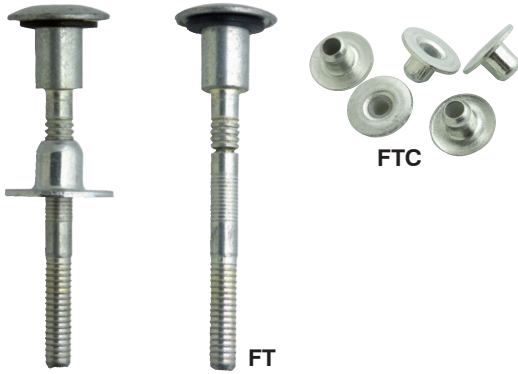

FEATURES

- Material:**
- White zinc plated steel
- Avantages:**
- Tamperproof / vibration resistant
 - High shear strengths
 - Waterproof/air tight
 - Grip range identified by coloured plastic washer under the head (see table "colour code")



DIMENSIONS & REFERENCES

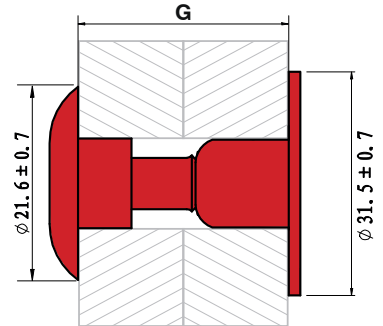
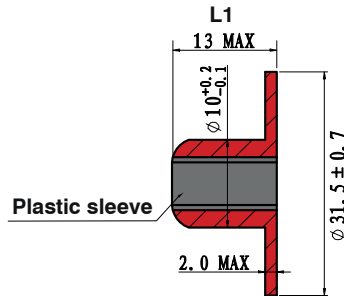
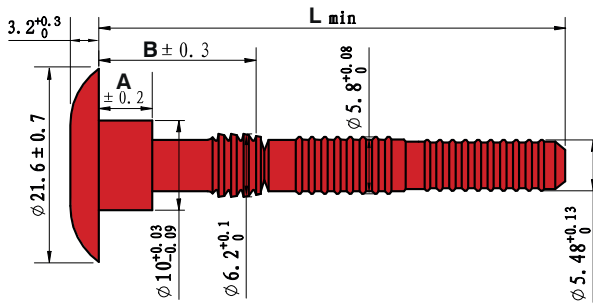

BOLTS FT:

L	A	B	G	Colour	Reference
mm	mm	mm	mm		
52.0	-	12.6	12.8-15.8	Black	FT1209S
52.0	-	14.1	14.3-17.5	Black	FT1210S
54.0	4.6	15.2	15.9-19.0	Blue	FT1211S
56.0	6.0	16.8	17.5-20.6	Yellow	FT1212S
56.0	7.9	18.4	19.1-22.2	Black	FT1213S
58.0	9.5	20.0	20.7-23.8	Green	FT1214S

L	A	B	G	Colour	Reference
mm	mm	mm	mm		
60.0	10.9	21.6	22.2-25.4	Brown	FT1215S
62.0	12.5	23.2	23.9-26.9	Orange	FT1216S
71.0	14.2	24.7	25.4-28.5	White	FT1217S
71.0	14.2	26.3	27.0-30.1	Red	FT1218S
71.0	14.2	25.5	30.1-33.3	Blue	FT1220S

SHELL FTC: Reference FTC1200SF

INSTALLATION DATA

Drill size mm	Clamp force N	Tensile	
		Grip min. N	Grip max. N
Ø10.3-10.6	2 200	6 700	4 400

NB: the strength of the joints may vary with the thickness and hardness of the metal sheet of the application as well as with the quality of the GRP board.

APPLICATION EXAMPLES

- For clamping "GRP" vehicle panel ("glass-reinforced plastic")
- For clamping rubber to metal
- Container manufacture



SETTING TOOLS

Element 7 Setting tool + Kit 6 Ref: E-7-2XBAT-KIT6

E640PC Setting tool Ref: E640PC

