

**GD GROOVED 3.2/4.0/4.8**

Mandrel: Steel. Body: Aluminium. Dome Head.

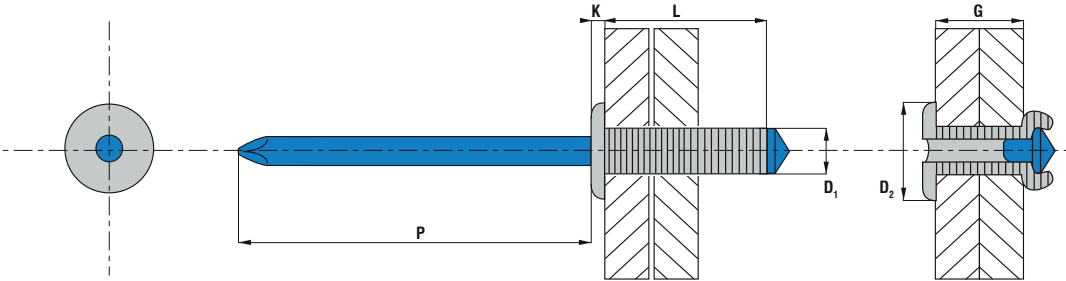

Part No/REF	D <sup>1</sup> Ø(mm)	L (mm)+1.0/-0.2	D <sup>2</sup> Ø(mm)	K (mm)	Hole Diameter Ø(mm)	P mini (mm)	G min-max (mm)
GD3210	3.2 +0.30/ -0.0	10.0	6.3	1.7	3.4	26.0	6.0
GD3214		14.0	-0.29/ +0.29				10.0
GD4008	4.0 +0.35/ -0.0	8.0	8.0 -0.29/ +0.29	1.7	4.3	27.0	4.0
GD4010		10.0					6.0
GD4012		12.0					8.0
GD4016		16.0					12.0
GD4810	4.8 +0.35/ -0.0	10.0	9.5 -0.29/ +0.29	2.0	5.1	27.0	6.0
GD4811		11.0					7.0
GD4814		14.0					10.0
GD4816		16.0					12.0

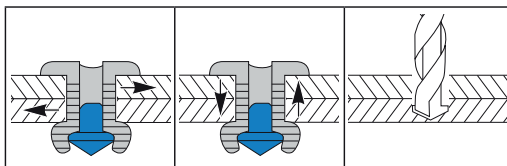

D <sup>1</sup> (mm)	(N)	(N)	Ø (mm)
3.2	525	930	3.4
4.0	885	1,410	4.3
4.8	1,185	1,575	5.1