

# MS OPEN END

Mandrel: Carbon Steel. Body: Monel 400 series. Dome Head. Body polishing mandrel Zinc plated.

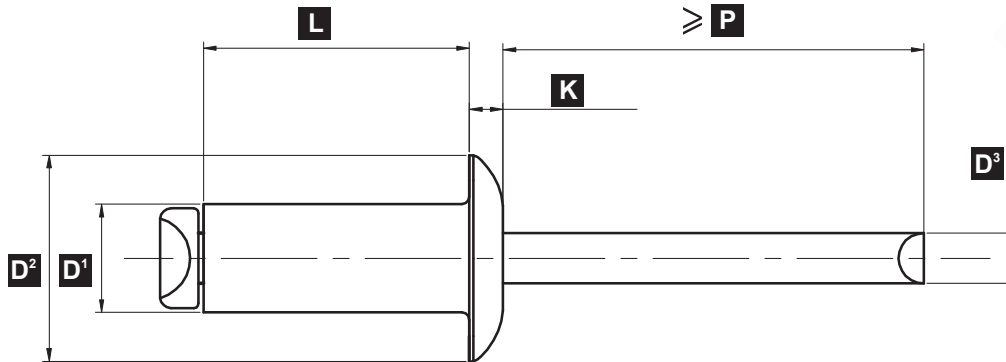

Part No/REF	D <sup>1</sup>	L	Grip Range	D <sup>2</sup>	D <sup>3</sup>	K	P	Drill size (mm)	Tensile N(min)	Shear N(min)
MS3206	Ø3.2 +0.08/-0.15	6	1.0 ~ 3.0	Ø6.2 +0.0 -0.4	Ø1.92 ±0.10	0.7 ±0.2	≥26	Ø3.3~3.4	1,900	1,500
MS3208		8	3.0 ~ 5.0							
MS3210		10	5.0 ~ 7.0							
MS3212		12	7.0 ~ 9.0							
MS4008	Ø4.0 +0.08/-0.15	8	3.0 ~ 5.0	Ø6.9 +0.0 -0.4	Ø2.35 ±0.10	0.9 ±0.2	≥27	Ø4.1~4.2	3,000	2,200
MS4010		10	5.0 ~ 6.5							
MS4012		12	6.5 ~ 8.5							
MS4808	Ø4.8 +0.08/-0.15	8	2.0 ~ 4.0	Ø8.4 +0.0 -0.55	Ø2.9 ±0.10	1.3 ±0.2	≥28	Ø4.9~5.0	3,750	3,300
MS4810		10	4.0 ~ 6.0							
MS4812		12	6.0 ~ 8.0							
MS4814		14	8.0 ~ 10.0							
MS4816		16	10.0 ~ 12.0							
MS4818		18	12.0 ~ 14.0							
MS4820		20	13.0 ~ 15.0							
MS6412	Ø6.4 +0.08/-0.15	12	4.0 ~ 6.0	Ø11.1 +0.0 -0.6	Ø3.8 ±0.10	1.6 ±0.2	≥32	Ø6.5~6.6	6,750	5,400
MS6418		18	10.0 ~ 12.0							
MS6425		25	12.0 ~ 19.0							