

NEW GENERATION LEVER TOOL FOR RIVET NUTS M4 - M10

N300

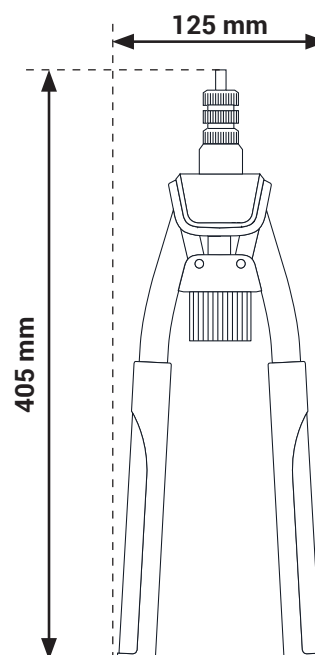

Weight = 1,4kg

FEATURES

1. Professional lever tool for rivet nuts
2. Geared transmission: 3x less effort than standard tools
3. Quick release rod (N300-T version)
4. 5 mandrels and nosepieces supplied: M4-M5-M6-M8-M10
5. Materials:
body and levers = steel
grip handle = ABS
6. 1 year warranty

CAPACITY

| RIVET NUTS | M4 | M5 | M6 | M8 | M10 |
|-----------------|----|----|----|----|-----|
| ALUMINIUM | ✓ | ✓ | ✓ | ✓ | ✓ |
| STEEL | ✓ | ✓ | ✓ | ✓ | ✓ |
| STAINLESS STEEL | ✓ | ✓ | ✓ | ✓ | ✓ |

PACKAGING



cardboard box : 505x185x45mm
Reference : **N300**



Aluminium box : 535x220x45mm
Reference : **N300-S**

Included :
1 N300 tool
5 mandrels and M4 - M10 nose pieces
Assortment of nuts (N300-S kit version)

MANUAL

Installing the Rivet nut



Fit the mandrel and nose that corresponds to the diameter of the rivet nut (M4, M5, M6, M8 or M10).

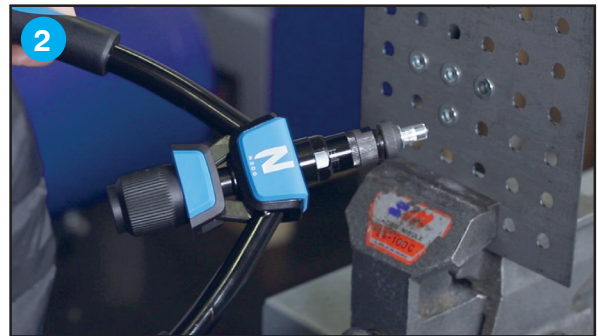

Fully spread the arms of the N300 and fit the rivet nut onto the mandrel as far as the anvil (nose cone).

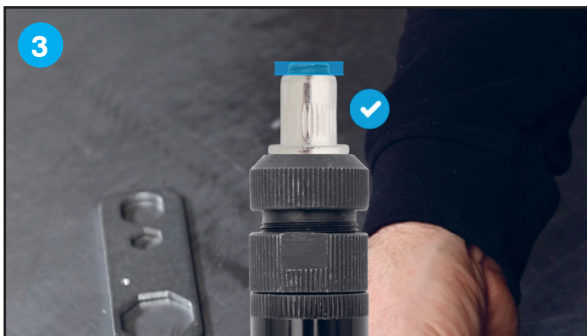

Advice: Let the mandrel protrude slightly to guarantee a good connection of the mandrel and rivet nut



To adjust the stroke: loosen the retaining nut then turn the anvil and sleeve parts to increase/reduce the stroke (possible adjustment from 1 to 10mm). Then retighten. Diagram shows the ideal rivet nut deformation.

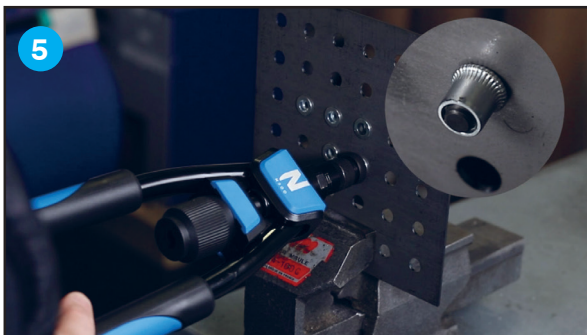

Setting the nut:
Insert the rivet nut in the plate drilling hole.
Close the arms of the tool to set the rivet nut.



Remove the tool:
open arms
Turn the knob to remove the N300 tool

CHANGING THE MANDRELS

Maintenance advice: remember to lubricate the mandrel regularly! This will extend its life and make it easier to set. To do this, simply dip the tie rod in a small pot of grease, screw/unscrew a nut, then wipe off the excess grease with a rag.

Watch the video

